



REGAL  
— STUDENTS —



23 North Holmes Road

Canterbury, Kent, CT1 1QR

£1,500 PCM



STUDENT ACCOMODATION 2024/25

- FOUR BEDROOM STUDENT HOUSE
- NEWLY FITTED KITCHEN
- Located behind Christ Church University
- Lounge/diner - Separate kitchen
- Ideal for CCU
- NO rent in July, HALF RENT AUGUST.
- £400 deposit per room
- Bill packages are available through a third party company. Please contact us direct for a quote.
- Students require an England based guarantor or to pay in advance. Housing hand will be accepted too.



Area Map



Floor Plans

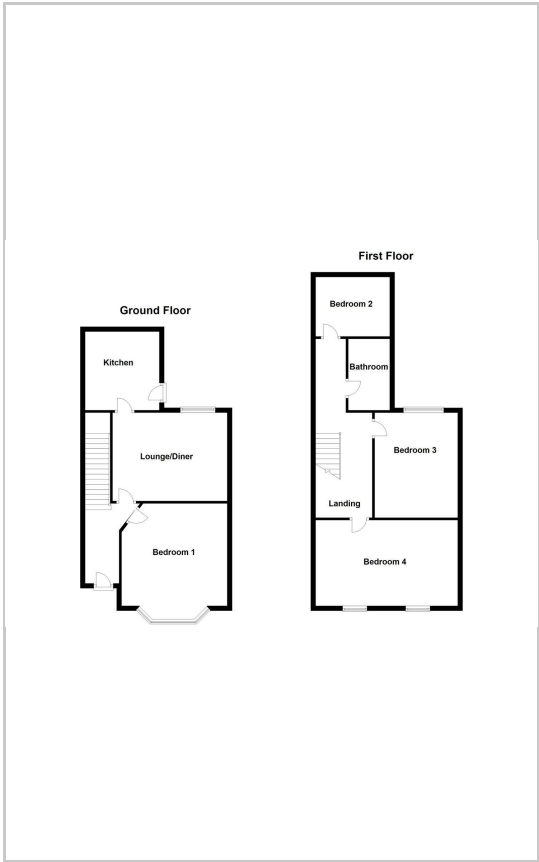

Energy Efficiency Graph

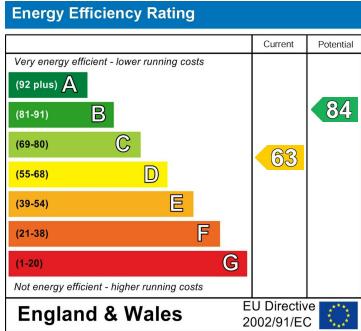

These particulars, whilst believed to be accurate are set out as a general outline only for guidance and do not constitute any part of an offer or contract. Intending purchasers should not rely on them as statements of representation of fact, but must satisfy themselves by inspection or otherwise as to their accuracy. No person in this firms employment has the authority to make or give any representation or warranty in respect of the property.